

WORKERS COMPENSATION - 19TH ANNUAL

NOVEMBER 10-12, 2010

LAS VEGAS CONVENTION CENTER - EXHIBIT HALL N3 - N4
LAS VEGAS, NV

REVISION DATE:
2/1/10 NP

BOOTH COUNT

Inventory as of 02/01/2010

Dimension	Size	Qty	SqFt
10'x10'	100	138	13,800
10'x20'	200	55	11,000
20'x20'	400	21	8,400
20'x30'	600	5	3,000
30'x50'	1,500	1	1,500

Totals: 220 37,700

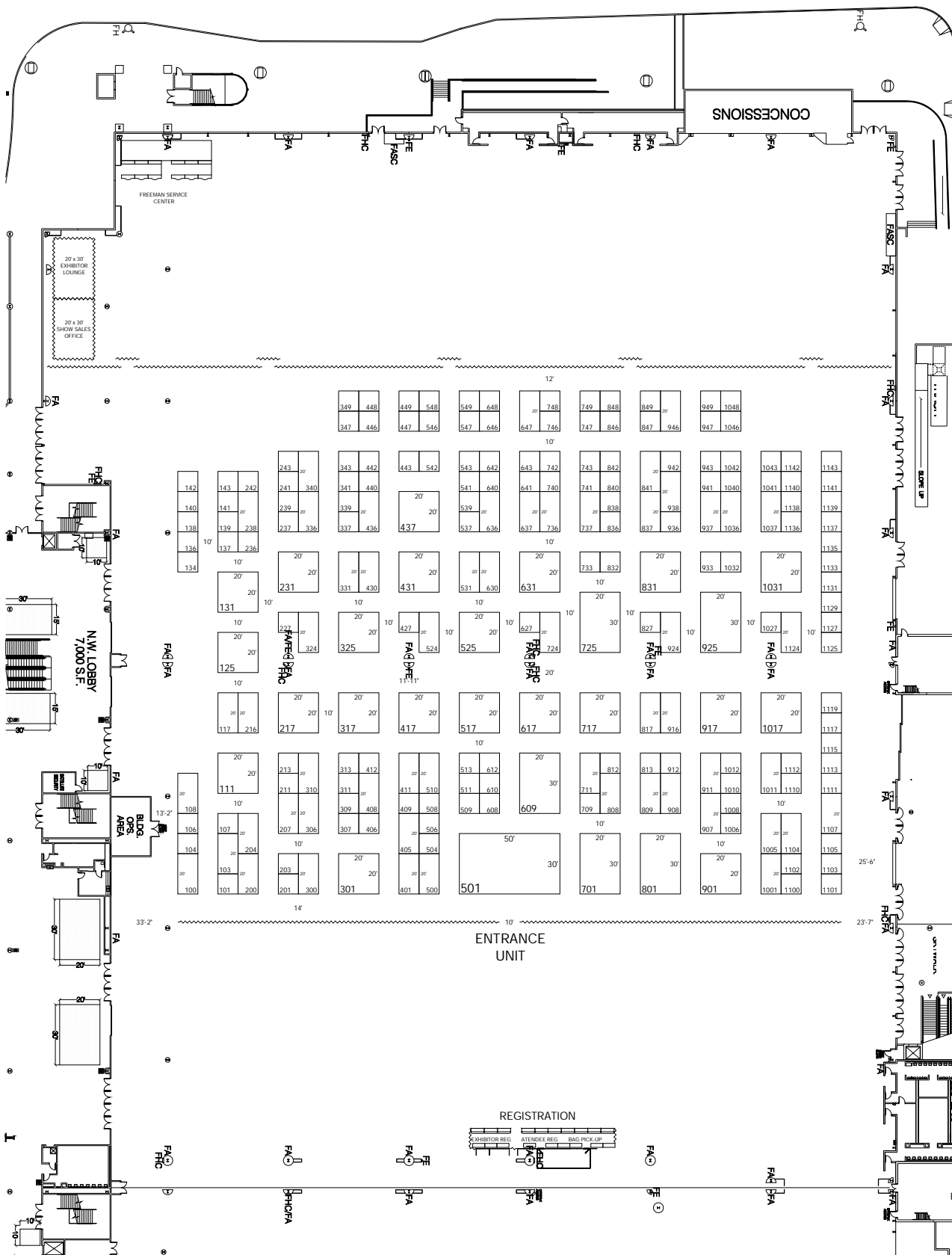

BLDG. LEGEND:

FREEMAN

DRAWING STARTED:
9/9/09 NP

FILE PATH:
O:\CAD\SHOWS 2010\LAS VEGAS
CONVENTION
CENTER\11-NOVEMBER\WORKER
COMPEN\19TH ANNUAL
WC 1110.DWG

FACILITY:
LVCC
PROJECT NUMBER:
233247
ACCOUNT EXECUTIVE:
M. Harris

SCALED TO FIT PAGE

DISCLAIMER

EVERY EFFORT HAS BEEN MADE TO ENSURE THE ACCURACY OF ALL INFORMATION CONTAINED ON THIS FLOORPLAN. HOWEVER NO WARRANTIES, EITHER EXPRESSED OR IMPLIED ARE MADE WITH RESPECT TO THIS FLOORPLAN. THE LOCATION OF BUILDING COLUMNS, UTILITIES OR OTHER ARCHITECTURAL COMPONENTS OF THE FACILITY IS A CONSIDERATION IN THE CONSTRUCTION OR USAGE OF AN EXHIBIT, IT IS THE SOLE RESPONSIBILITY OF THE EXHIBITOR TO PHYSICALLY INSPECT THE FACILITY TO VERIFY ALL DIMENSIONS AND LOCATIONS.

©COPYRIGHT 2007, FREEMAN CO. ALL RIGHTS RESERVED.